

SECTION II

TM 9-2330-213-14&P

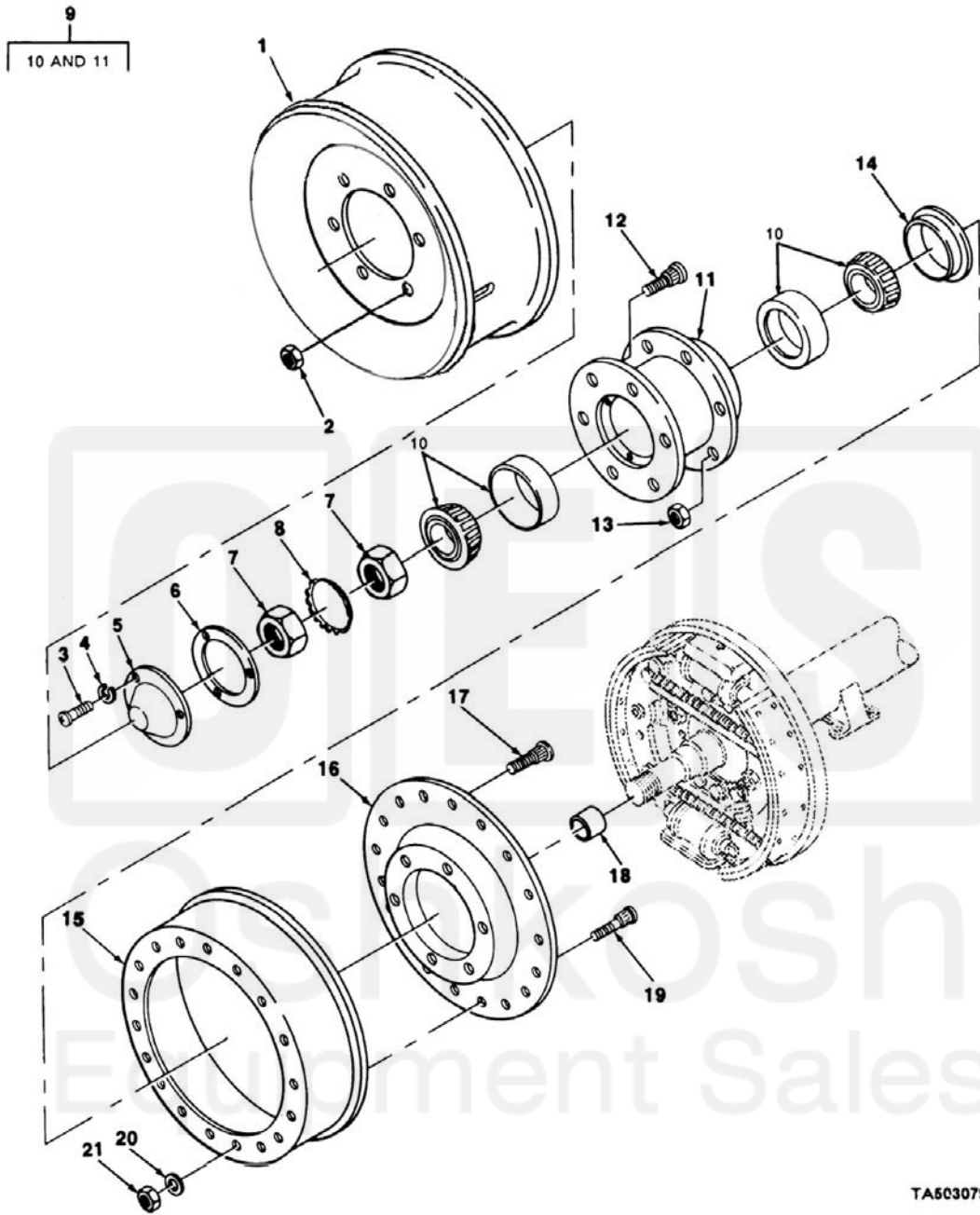

FIGURE 21. HUB AND DRUM ASSEMBLY (M103A3, M105A2, M105A2C, M107A2, M107A2C, M448).

TA603079

Change 1

SECTION II

TM9-2330-213-14&P

(1) ITEM NO	(2) SMR CODE	(3) CAGEC	(4) PART NUMBER	(5) DESCRIPTION AND USABLE ON CODES(UOC)	(6) QTY
GROUP 13 WHEELS					
1311 WHEEL ASSEMBLY					
FIG. 21 HUB AND (DRUM ASSEMBLY (M103A3, M105A2, M105A2C, M107A2, M107A2C, M448)					
1	PAOZZ	02686	129374	ASSEMBLY, WHEEL	2
				UOC:698,701,711,713,714,715	
2	PAOZZ	02686	129378	NUT,PLAIN,SINGLE BA WHEEL HUB	12
				UOC:698,701,711,713,714,715.....	
3	PAOZZ	96906	MS35206-279	SCREW,MACHINE	3
				UOC:698,701,711,713,714,715	
4	PAOZZ	96906	MS35338-63	WASHER,LOCK.....	3
				UOC:698,701,711,713,714,715	
5	PAOZZ	19200	6144454	HUB CAP,WHEEL.....	2
				UOC:698,701,711,713,714,715	
6	PAOZZ	19207	6144356	GASKET	2
				UOC:698,701,711,713,714,715	
7	PAOZZ	19207	7411379	NUT,PLAIN,OCTAGON.....	4
				UOC:698,701,711,713,714,715	
8	PAOZZ	19207	7411378	WASHER,KEY	2
				UOC:701,711,713,714,	
8	PAOZZ	19207	7411378	WASHER,KEY	4
				UOC:698,715	
9	PAOZZ	09386	71423E	HUB AND CUP ASSEMBLY	2
				UOC:698,701,711,713,714,715	
10	PAOZZ	96906	MS19081-230	.CONE AND ROLLERS,TA	2
				UOC:698,701,711,713,714,715	
11	PAOZZ	19207	8719915	.HUB.....	2
				UOC:698,701,711,713,714,715	
12	PAOZZ	96906	MS51946-2	BOLT,RIBBED SHOULDER RIGHT HAND.....	12
				UOC:698,701,711,713,714,715	
13	PAOZZ	96906	MS51922-61	NUT,PLAIN,SLOTTED,H.....	12
				UOC:698,701,711,713,714,715	
14	PAOZZ	19207	7411429	SEAL,PLAIN ENCASED.....	2
				UOC:698,701,711,713,714,715	
15	PAOZZ	19207	7411425	BRAKE DRUM	2
				UOC:698,701,711,713,714,715	
16	PAOZZ	19207	7413231	PLATE,BACKING,BRAKE.....	2
				UOC:698,701,711,713,714,715	
17	PAOZZ	96906	MS51946-11	BOLT,RIBBED SHOULDER.....	12
				UOC:698,701,711,713,714,715	
18	PAOZZ	19207	7411433	SPACER,SLEEVE.....	2
				UOC:698,701,711,713,714,715	
19	PAOZZ	19207	8720025	BOLT,RIBBED NECK.....	36
				UOC:698,701,711,713,714,715	
20	PAOZZ	96906	MS27183-14	WASHER,FLAT	36
				UOC:698,701,711,713,714,715	
21	PFOZZ	96906	MS21045-6	NUT,SELF-LOCKING,HE.....	36
				UOC:698,701,711,713,714,715	